

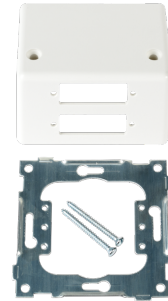

Data Sheet 6942625

Product: L917/71 2 x fiber SC dob. PH
EI-number: 6942625
Mat.no: EKO09209
EAN: 7020160920911
Packing: 10
Color: Polarwhite



Product description: RS16 centralplate, angled 45 degrees with cutout for 2 x FIBER SC double. Delivered with 2 screws, made of thermoplastic, fits into all RS16 combinationplates, Inclusive a steel mounting ring fitted for flush mounted boxes with screwdistance cc 60 mm. Combinationplates to be ordered separately

Technical specifications: ELKO RS16 single angled 45 degrees centralplate with cutout for 2 x FIBER SC double
Color: Polarwhite
Halogenfree
56x56 mm
Cutout: 26 x 9,8 mm.
Mounting distance: 30 mm

Size

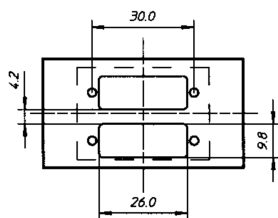

Wiring diagram

ELKO AS

E-mail: elko@elko.no
Internet: www.elko.no
Bank: 6219.05.15880
Org.no.: NO 911 382 563 MVA

ELKO Front office
Sandstuveien 68, NO-0680 Oslo
P.O.Box 6598 Etterstad, NO-0607 Oslo
Tel.: +47 67 80 73 00
Fax: +47 67 80 73 01

ELKO Plant
Sporpind Industriområde, NO-3340 Åmot
Tel.: +47 32 78 91 00
Fax: +47 32 78 91 01